

AirBase® lightweight screed is suitable for direct processing on Lewis® dovetailed sheeting®

AirBase® lightweight screed:

- 70% lighter than traditional sand cement screed or concrete
- High strength and hardness (C12/F3)
- Very fast setting time (walkable after 3 hours*)
- Can be tiled after 12 hours
- Completely dry and able to take weight after 1 week
- Suitable for underfloor heating systems
- Moisture resistant

* in floors supporting construction

Application of AirBase® on Lewis® dovetailed sheeting®:

- Maximum girder distance 700 mm c.t.c.
- Total thickness of layer of AirBase®
 - minimum of 50 mm
 - minimum of 25 mm on piping/tubes
- Maximum permissible load
 - 175 kg per m² and
 - 300 kg point load on load surface 500 x 500 mm
- Walkable after 24 hours
- Total weight Lewis® sheeting with Airbase® less than 40 kg per m²
- Finishing with hard floor covering such as tiles, laminate or parquet
- Finishing with soft floor covering, PVC or coating; level off first

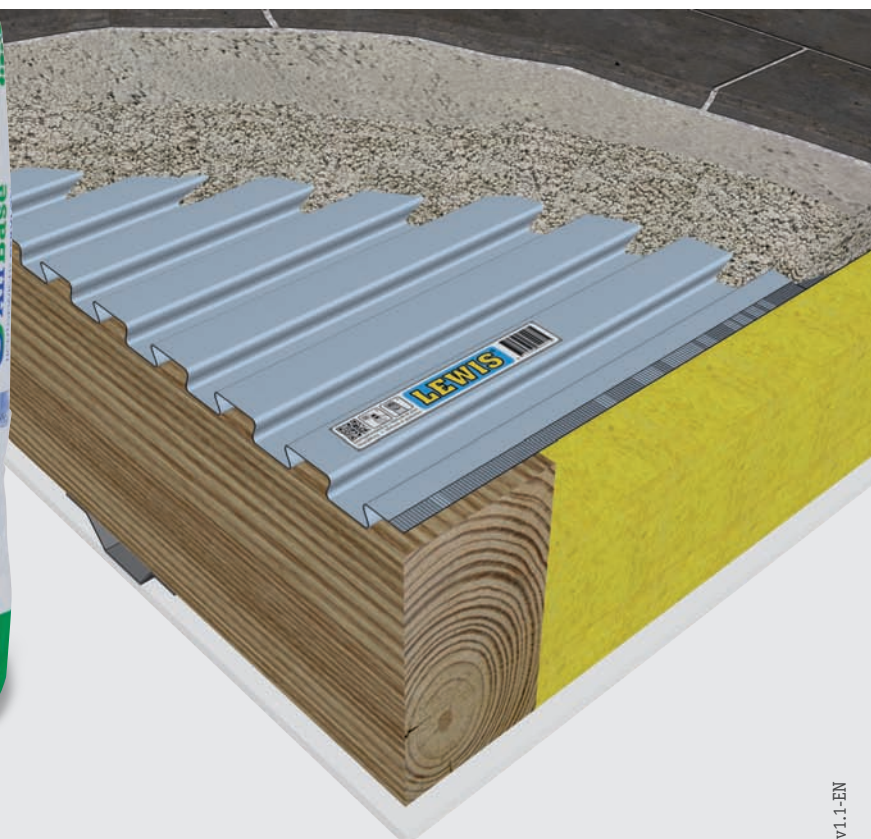

Further information

If you have any specific questions, please contact us via info@airbase.eu or +31 (0)570 50 38 30

www.airbase.eu